

Pleasant Square

788 Pleasant Ave, Oregon City, OR 97045 |
503-557-1714



Enjoy Something Extra

At Pleasant Square Apartments, you'll find our 2 bedroom, single level units extra nice when you discover all the features we have to offer. Imagine having your own fenced-in backyard with a patio to relax, play or enjoy gardening. Each unit has large closets and a washer and dryer hook-up. The lush landscape and quiet setting makes Pleasant Square perfect for someone looking for something extra. Stop by Pleasant Square today and see why we are right for you.

Complex Features

- On-site maintenance
- Dishwasher
- Stove and refrigerator
- Disposal
- Washer/dryer hookups
- Ceiling fans
- Patio
- Courtyard
- Playground
- Reserved parking
- Visitor parking
- Pets welcome
- Locking mailboxes
- Free local faxing available
- One block to Tri-Met bus stop
- Easy access to I-205
- Near schools and Clackamas
- Community College
- Near shopping centers

Rental Rates

2 Bd Only:
From \$770 - 1 year lease

Application charge: \$25



Area Schools

King - Elementary
995 Southend Road
503-785-8250

Gardner - Jr. High School
180 Ethel Street
503-785-8200

Oregon City - High School
19761 S. Beaver creek Road
503-785-8900

Clackamas Community College
19600 S. Molalla Avenue
503-657-6958

View Floor Plans

[2B](#)

Prices subject to change without notice

Directions

788 Pleasant Ave, Oregon City, OR 97045

From Hwy 205:

Take exit 9 to McLoughlin

Day Care

Check Local Listings

Pets

Pets are welcome.
20 lbs and under at full growth.

Pet fee: \$200 - per pet nonrefundable

Blvd. Turn left (south) onto McLoughlin and travel to 10th St. 10th St. becomes Singer Hill Road. Turn left onto 7th St. 7th becomes Molalla Ave. at the hilltop. Turn right onto Molalla Ave. Travel past Pearl St. and turn right onto Pleasant Ave. Pleasant Square Apartments is on the right.

[View Map](#)

Pleasant Square

788 Pleasant Ave, Oregon City, OR 97045 | 503-557-1714

Floor Plans

2 Bedroom

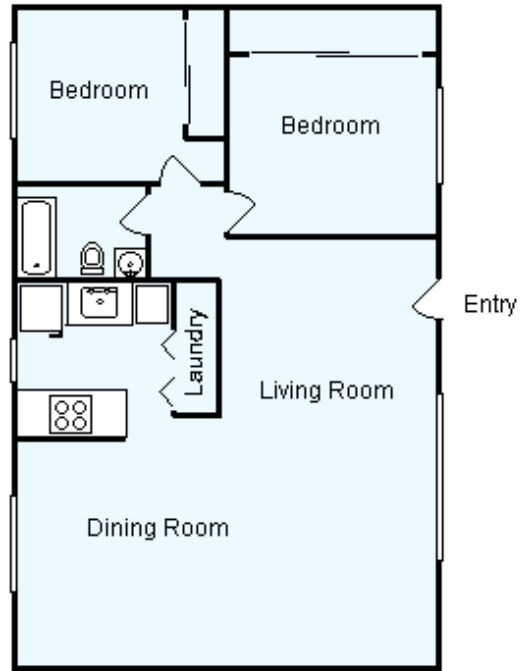

Pleasant Square

788 Pleasant Ave, Oregon City, OR 97045 | 503-557-1714

Photo Gallery

Click on the Images to Enlarge



Canyon Property Management Properties:

-- Choose a Community --

[Print Your \\$50 Coupon](#)

Call: (503) 557-1714
for complete rental information.

✓ Let us tell you about a Great Place to Live.

 Equal Housing Opportunity

Home Office: 6823 SW Canyon Road
Portland, OR 97225 | 503.297.2542 | [email](#)
Fax 503.297.9047 | Toll Free 1.888.236.3798

 EQUAL HOUSING OPPORTUNITY

Canyon Property Management 2007 All Rights Reserved.
Unauthorized use prohibited.
[Privacy Policy](#)